

1 Site Section C-C
1 : 500



2 Site Section C-C Part 01
1 : 200



3 Site Section C-C Part 02
1 : 200

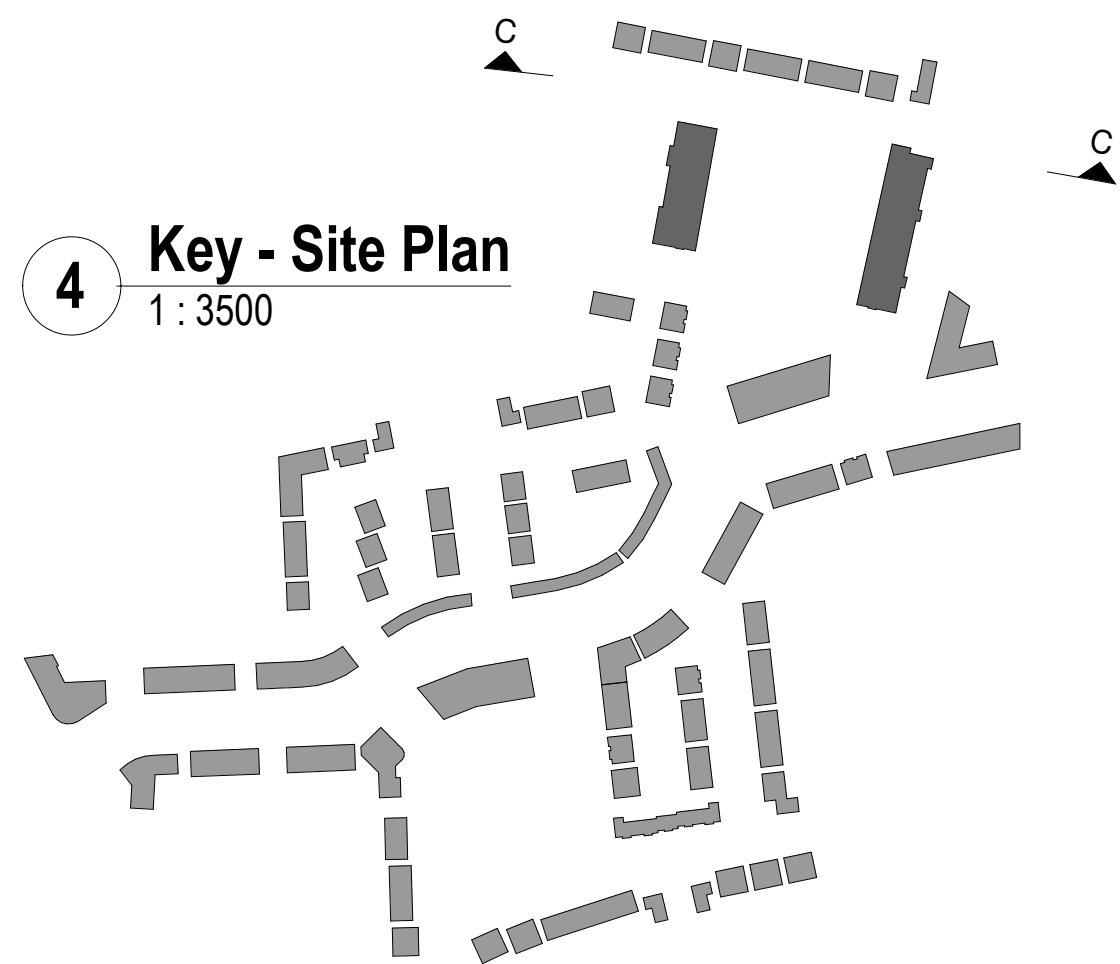

4 Key - Site Plan
1 : 3500

CPR Note:
All works to be carried out using proper materials which are fit for the use they are intended and for the condition in which they are to be used.

All materials used in connection with the works to comply with the Construction Products Regulation (EU) No. 305/2011 and the harmonised technical specification/standards that fall within the remit of the CPR No. 305/2011

	van Dijk Architects MILL HOUSE, MILL STREET, DUNDALK, CO. LOUTH PH. 042-9354466 FAX. 042-9354460 INFO@VANDIJKARCHITECTS.COM
---	---

DRAWING TITLE
SITE SECTION C-C

SCALE	VARIABLE	DRAWING NUMBER	1757-PA-017	JOB	CLONMINGH
REVISION	SIZE	CAD REFERENCE		CLIENT	STEINFORT INVESTMENTS
REVISED BY	BG	DRAWING BY	AC	DATE	18.10.2021

NOTE
IF DIMENSIONS MUST BE USED IN PREFERENCE TO SCALED DIMENSIONS, ANY DISCREPANCIES MUST BE REPORTED TO THE ARCHITECT IMMEDIATELY. THIS DRAWING REMAINS THE COPYRIGHT OF VAN DIJK ARCHITECTS. IT MUST NOT BE USED FOR ANY PURPOSE BEYOND THAT FOR WHICH IT WAS ISSUED WITHOUT THE EXPRESSED APPROVAL OF VAN DIJK ARCHITECTS. THESE DRAWINGS OR ANY ADDITIONAL INFORMATION WITHOUT THE EXPRESSED APPROVAL OF VAN DIJK ARCHITECTS