



1 Site Section D-D
1 : 600



2 Site Section D-D Part 01
1 : 200



3 Site Section D-D Part 02
1 : 200

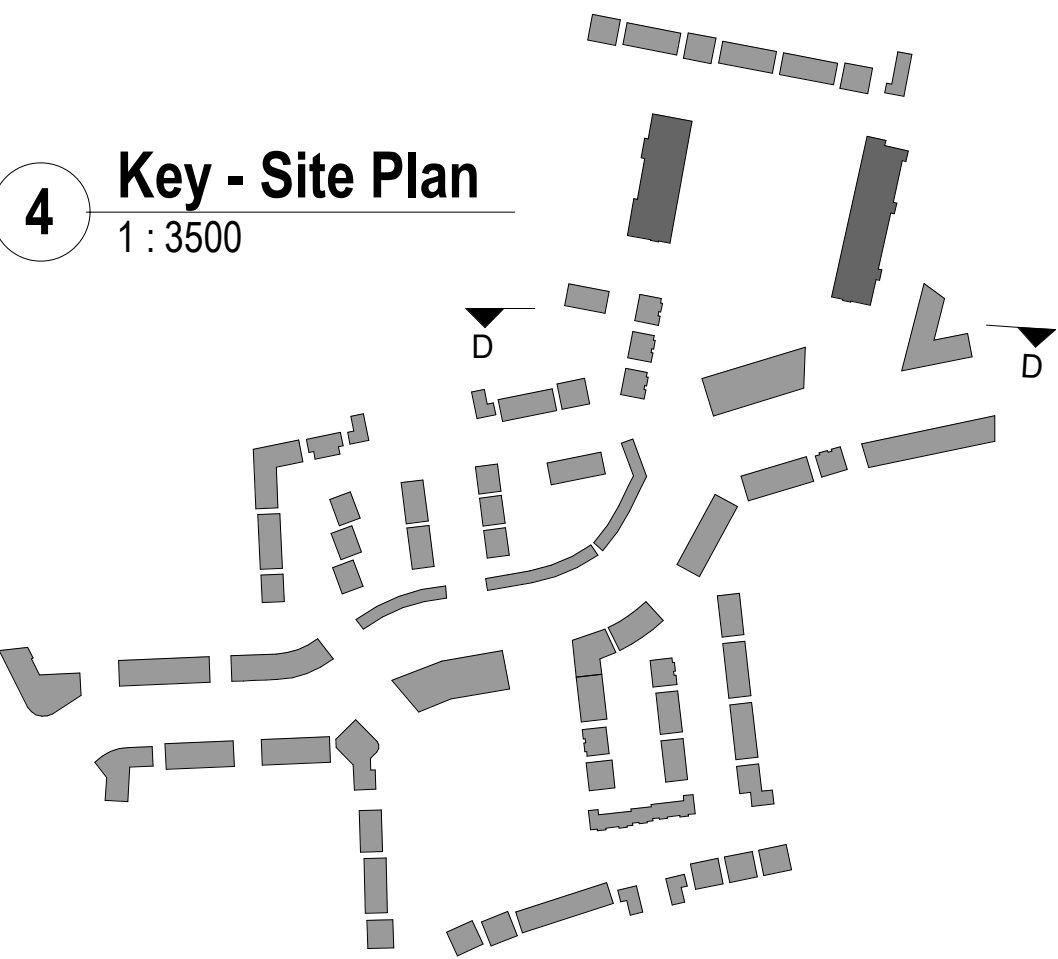

4 Key - Site Plan
1 : 3500

CPR Note:
All works to be carried out using proper materials which are fit for the use they are intended and for the condition in which they are to be used.

All materials used in connection with the works to comply with the Construction Products Regulation (EU) No. 305/2011 and the harmonised technical specification/standards that fall within the remit of the CPR No. 305/2011



DRAWING TITLE
SITE SECTION D-D

SCALE	VARIABLES	DRAWING NUMBER	1757-PA-018	JOB	CLONMINGH
REVISION	SIZE	CAD REFERENCE		CLIENT	STEINFORT INVESTMENTS
REVISED BY	BG	DRAWING BY	AC	DATE	18.10.2021

NOTE
IF DIMENSIONS MUST BE USED IN PREFERENCE TO SCALE DIMENSIONS, ANY DISCREPANCIES MUST BE REPORTED TO THE ARCHITECT IMMEDIATELY. THIS DRAWING REMAINS THE COPYRIGHT OF VAN DIJK ARCHITECTS. IT MUST NOT BE USED FOR ANY PURPOSES WITHOUT THE EXPRESSED APPROVAL OF VAN DIJK ARCHITECTS. NO COPY OR REDISTRIBUTION OF THESE DRAWINGS OR ANY ADDITIONAL INFORMATION WITHOUT THE EXPRESSED APPROVAL OF VAN DIJK ARCHITECTS