

Block D -Ground Floor Plan

1:100

Apartment W1 (2no.)

Apartment	Dwelling Type	Gross Floor Area	Aggregate living area	Aggregate bedroom area	Storage	Private Amenity Space
Target	1 Bed 2 <sup>nd</sup> Apart.	45 m <sup>2</sup>	23 m <sup>2</sup>	11.4 m <sup>2</sup>	3 m <sup>2</sup>	5 m <sup>2</sup>
Proposed W1	1 Bed 2 <sup>nd</sup> Apart.	49.5 m <sup>2</sup>	22.7 m <sup>2</sup>	12.3 m <sup>2</sup>	4.14 m <sup>2</sup>	6.77 m <sup>2</sup>

Apartment W2 (2no.) 4 no. Part V

Apartment	Dwelling Type	Gross Floor Area	Aggregate living area	Aggregate bedroom area	Storage	Private Amenity Space
Target	1 Bed 2 <sup>nd</sup> Apart.	45 m <sup>2</sup>	23 m <sup>2</sup>	11.4 m <sup>2</sup>	3 m <sup>2</sup>	5 m <sup>2</sup>
Proposed W2	1 Bed 2 <sup>nd</sup> Apart.	53 m <sup>2</sup>	24.4 m <sup>2</sup>	12.3 m <sup>2</sup>	4.36 m <sup>2</sup>	11.71 m <sup>2</sup>

Apartment X1 (2no.)

Apartment	Dwelling Type	Gross Floor Area	Aggregate living area	Aggregate bedroom area	Storage	Private Amenity Space
Target	2 Bed 4 <sup>th</sup> Apart.	74 m <sup>2</sup>	30 m <sup>2</sup>	24.4 m <sup>2</sup>	6 m <sup>2</sup>	6 m <sup>2</sup>
Proposed X1	2 Bed 4 <sup>th</sup> Apart.	86 m <sup>2</sup>	37.5 m <sup>2</sup>	24.6 m <sup>2</sup>	6.88 m <sup>2</sup>	9.8 m <sup>2</sup>

Apartment X2 (4no.)

Apartment	Dwelling Type	Gross Floor Area	Aggregate living area	Aggregate bedroom area	Storage	Private Amenity Space
Target	2 Bed 4 <sup>th</sup> Apart.	74 m <sup>2</sup>	30 m <sup>2</sup>	24.4 m <sup>2</sup>	6 m <sup>2</sup>	6 m <sup>2</sup>
Proposed X2	2 Bed 4 <sup>th</sup> Apart.	78 m <sup>2</sup>	30.4 m <sup>2</sup>	25 m <sup>2</sup>	6.05 m <sup>2</sup>	9.67 m <sup>2</sup>

Apartment X3 (2no.)

Apartment	Dwelling Type	Gross Floor Area	Aggregate living area	Aggregate bedroom area	Storage	Private Amenity Space
Target	2 Bed 4 <sup>th</sup> Apart.	74 m <sup>2</sup>	30 m <sup>2</sup>	24.4 m <sup>2</sup>	6 m <sup>2</sup>	6 m <sup>2</sup>
Proposed X3	2 Bed 4 <sup>th</sup> Apart.	78.5 m <sup>2</sup>	30.6 m <sup>2</sup>	24.9 m <sup>2</sup>	6.04 m <sup>2</sup>	8.76 m <sup>2</sup>

Apartment X4 (2no.)

Apartment	Dwelling Type	Gross Floor Area	Aggregate living area	Aggregate bedroom area	Storage	Private Amenity Space
Target	2 Bed 4 <sup>th</sup> Apart.	74 m <sup>2</sup>	30 m <sup>2</sup>	24.4 m <sup>2</sup>	6 m <sup>2</sup>	6 m <sup>2</sup>
Proposed X4	2 Bed 4 <sup>th</sup> Apart.	84.2 m <sup>2</sup>	30.7 m <sup>2</sup>	27.4 m <sup>2</sup>	6.14 m <sup>2</sup>	9.72 m <sup>2</sup>

Apartment X5 (2no.)

Apartment	Dwelling Type	Gross Floor Area	Aggregate living area	Aggregate bedroom area	Storage	Private Amenity Space
Target	2 Bed 4 <sup>th</sup> Apart.	74 m <sup>2</sup>	30 m <sup>2</sup>	24.4 m <sup>2</sup>	6 m <sup>2</sup>	6 m <sup>2</sup>
Proposed X5	2 Bed 4 <sup>th</sup> Apart.	81.2 m <sup>2</sup>	30.3 m <sup>2</sup>	26.9 m <sup>2</sup>	6.0 m <sup>2</sup>	8.8 m <sup>2</sup>

Apartment X6 (1no.)

Apartment	Dwelling Type	Gross Floor Area	Aggregate living area	Aggregate bedroom area	Storage	Private Amenity Space
Target	2 Bed 4 <sup>th</sup> Apart.	74 m <sup>2</sup>	30 m <sup>2</sup>	24.4 m <sup>2</sup>	6 m <sup>2</sup>	7 m <sup>2</sup>
Proposed X6	2 Bed 4 <sup>th</sup> Apart.	100 m <sup>2</sup>	39 m <sup>2</sup>	29.3 m <sup>2</sup>	11.9 m <sup>2</sup>	34.76 m <sup>2</sup>

Apartment X7 (1no.)

Apartment	Dwelling Type	Gross Floor Area	Aggregate living area	Aggregate bedroom area	Storage	Private Amenity Space
Target	2 Bed 4 <sup>th</sup> Apart.	74 m <sup>2</sup>	30 m <sup>2</sup>	24.4 m <sup>2</sup>	6 m <sup>2</sup>	7 m <sup>2</sup>
Proposed X7	2 Bed 4 <sup>th</sup> Apart.	91 m <sup>2</sup>	36.3 m <sup>2</sup>	26.1 m <sup>2</sup>	10.61 m <sup>2</sup>	37.7 m <sup>2</sup>

Apartment X8 (1no.)

Apartment	Dwelling Type	Gross Floor Area	Aggregate living area	Aggregate bedroom area	Storage	Private Amenity Space
Target	2 Bed 3 <sup>rd</sup> Apart.	63 m <sup>2</sup>	28 m <sup>2</sup>	20.1 m <sup>2</sup>	5 m <sup>2</sup>	6 m <sup>2</sup>
Proposed X8	2 Bed 3 <sup>rd</sup> Apart.	75 m <sup>2</sup>	29.5 m <sup>2</sup>	24.1 m <sup>2</sup>	5.79 m <sup>2</sup>	8.88 m <sup>2</sup>

Apartment Y1 (1no.)

Apartment	Dwelling Type	Gross Floor Area	Aggregate living area	Aggregate bedroom area	Storage	Private Amenity Space
Target	3 Bed 6 <sup>th</sup> Apart.	90 m <sup>2</sup>	34 m <sup>2</sup>	31.5 m <sup>2</sup>	9 m <sup>2</sup>	9 m <sup>2</sup>
Proposed Y1	3 Bed 6 <sup>th</sup> Apart.	109.4 m <sup>2</sup>	37.9 m <sup>2</sup>	40.9 m <sup>2</sup>	9.4 m <sup>2</sup>	142.5 m <sup>2</sup>

Apartment Y2 (1no.)

Apartment	Dwelling Type	Gross Floor Area	Aggregate living area	Aggregate bedroom area	Storage	Private Amenity Space
Target	3 Bed 6 <sup>th</sup> Apart.	90 m <sup>2</sup>	34 m <sup>2</sup>	31.5 m <sup>2</sup>	9 m <sup>2</sup>	9 m <sup>2</sup>
Proposed Y2	3 Bed 6 <sup>th</sup> Apart.	116.4 m <sup>2</sup>	39.1 m <sup>2</sup>	41.8 m <sup>2</sup>	13.2 m <sup>2</sup>	34.9 m <sup>2</sup>

Apartment Y3 (1no.)

Apartment	Dwelling Type	Gross Floor Area	Aggregate living area	Aggregate bedroom area	Storage	Private Amenity Space
Target	3 Bed 6 <sup>th</sup> Apart.	90 m <sup>2</sup>	34 m <sup>2</sup>	31.5 m <sup>2</sup>	9 m <sup>2</sup>	9 m <sup>2</sup>
Proposed Y3	3 Bed 5 <sup>th</sup> Apart.	101.1 m <sup>2</sup>	36.5 m <sup>2</sup>	33.7 m <sup>2</sup>	9.25 m <sup>2</sup>	18.5 m <sup>2</sup>

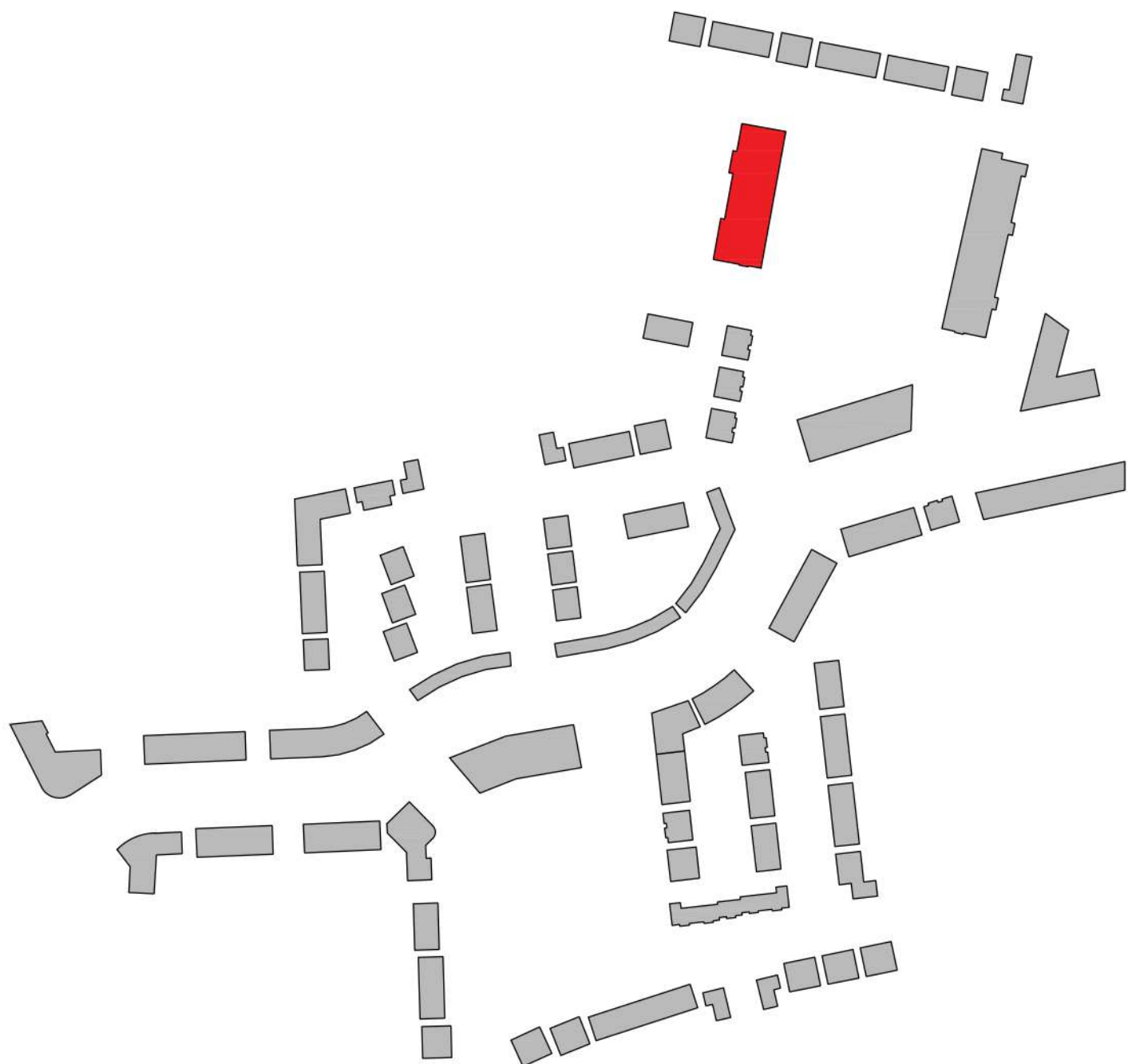

**CPR Note:**  
All works to be carried out using proper materials which are fit for the use they are intended and for the condition in which they are to be used.  
  
All materials used in connection with the works to comply with the Construction Products Regulation (EU) No. 305/2011 and the harmonised technical specification/standards that fall within the remit of the CPR No. 305/2011

**van Dijk Architects**  
MILL HOUSE, MILL STREET, DUNDALK, CO. LOUTH  
PH. 042-9354666 FAX. 042-9354660  
INFO@VANDIJKARCHITECTS.COM

DRAWING TITLE

Part V - Block D - 2 Units - Ground Floor

SCALE

AS INDICATED

DRAWING NUMBER

1757-PA-056

JOB

CLONMINTH TULLAMORE

DESIGNED BY

AI

CAD/REVISIONS

1757-PA-BLD

CLIENT

STEINFORT INVESTMENT

DRAWN BY

-

CHECKED BY

AC

DATE

July 2021

NOTE

FIGURED DIMENSIONS MUST BE USED IN PREFERENCE TO SCALED DIMENSIONS. ANY DIMENSIONAL DISCREPANCIES MUST BE REPORTED TO THE ARCHITECT IMMEDIATELY. THIS DRAWING REMAINS THE COPYRIGHT OF VAN DIJK ARCHITECTS. IT MUST NOT BE USED FOR ANY PURPOSE, BUILDING OR OTHERWISE WITHOUT THE EXPRESS PERMISSION OF THIS PRACTICE. DO NOT COPY OR REPRODUCE THESE DRAWINGS OR ANY ADDITIONAL INFORMATION WITHOUT THE EXPRESSED APPROVAL OF vanDijk Architects