



**Block B -First Floor Plan**

1:100

Apartment - Block B

Apartment W1 (Two)

Quality Housing for Sustainable Communities space provision						
Apartment	Dwelling Type	Gross Floor Area	Aggregate living area	Aggregate bedroom area	Storage	Private Amenity Space
Target	1 Bed 2 <sup>p</sup> Apart.	45 m <sup>2</sup>	23 m <sup>2</sup>	11.4 m <sup>2</sup>	3 m <sup>2</sup>	3 m <sup>2</sup>
Proposed W1	1 Bed 2 <sup>p</sup> Apart.	62.9 m <sup>2</sup>	33.5 m <sup>2</sup>	14.1 m <sup>2</sup>	3.0 m <sup>2</sup>	12.9 m <sup>2</sup>

Apartment X1 (Two)

Quality Housing for Sustainable Communities space provision						
Apartment	Dwelling Type	Gross Floor Area	Aggregate living area	Aggregate bedroom area	Storage	Private Amenity Space
Target	2 Bed 4 <sup>p</sup> Apart.	74 m <sup>2</sup>	30 m <sup>2</sup>	24.4 m <sup>2</sup>	6 m <sup>2</sup>	6 m <sup>2</sup>
Proposed X1	2 Bed 4 <sup>p</sup> Apart.	83.5 m <sup>2</sup>	30.01 m <sup>2</sup>	26 m <sup>2</sup>	6 m <sup>2</sup>	25 m <sup>2</sup>

Apartment X2 (Two)

Quality Housing for Sustainable Communities space provision						
Apartment	Dwelling Type	Gross Floor Area	Aggregate living area	Aggregate bedroom area	Storage	Private Amenity Space
Target	2 Bed 4 <sup>p</sup> Apart.	74 m <sup>2</sup>	30 m <sup>2</sup>	24.4 m <sup>2</sup>	6 m <sup>2</sup>	6 m <sup>2</sup>
Proposed X2	2 Bed 4 <sup>p</sup> Apart.	79.6 m <sup>2</sup>	31.3 m <sup>2</sup>	25.1 m <sup>2</sup>	6 m <sup>2</sup>	16.1 m <sup>2</sup>

Apartment X3 (Two)

Quality Housing for Sustainable Communities space provision						
Apartment	Dwelling Type	Gross Floor Area	Aggregate living area	Aggregate bedroom area	Storage	Private Amenity Space
Target	2 Bed 4 <sup>p</sup> Apart.	74 m <sup>2</sup>	30 m <sup>2</sup>	24.4 m <sup>2</sup>	6 m <sup>2</sup>	6 m <sup>2</sup>
Proposed X3	2 Bed 4 <sup>p</sup> Apart.	85.8 m <sup>2</sup>	35.7 m <sup>2</sup>	25.3 m <sup>2</sup>	6 m <sup>2</sup>	10.6 m <sup>2</sup>

Apartment X4 (Two) - 4 no. Part V Units

Quality Housing for Sustainable Communities space provision						
Apartment	Dwelling Type	Gross Floor Area	Aggregate living area	Aggregate bedroom area	Storage	Private Amenity Space
Target	2 Bed 4 <sup>p</sup> Apart.	74 m <sup>2</sup>	30 m <sup>2</sup>	24.4 m <sup>2</sup>	6 m <sup>2</sup>	6 m <sup>2</sup>
Proposed X4	2 Bed 4 <sup>p</sup> Apart.	74.0 m <sup>2</sup>	30.1 m <sup>2</sup>	25.2 m <sup>2</sup>	6 m <sup>2</sup>	8 m <sup>2</sup>

Apartment X5 (Two)

Quality Housing for Sustainable Communities space provision						
Apartment	Dwelling Type	Gross Floor Area	Aggregate living area	Aggregate bedroom area	Storage	Private Amenity Space
Target	2 Bed 4 <sup>p</sup> Apart.	74 m <sup>2</sup>	30 m <sup>2</sup>	24.4 m <sup>2</sup>	6 m <sup>2</sup>	6 m <sup>2</sup>
Proposed X5	2 Bed 4 <sup>p</sup> Apart.	94.6 m <sup>2</sup>	31.3 m <sup>2</sup>	32.8 m <sup>2</sup>	8.2 m <sup>2</sup>	13.6 m <sup>2</sup>

Apartment X6 (Two)

Quality Housing for Sustainable Communities space provision						
Apartment	Dwelling Type	Gross Floor Area	Aggregate living area	Aggregate bedroom area	Storage	Private Amenity Space
Target	2 Bed 4 <sup>p</sup> Apart.	74 m <sup>2</sup>	30 m <sup>2</sup>	24.4 m <sup>2</sup>	6 m <sup>2</sup>	6 m <sup>2</sup>
Proposed X6	2 Bed 4 <sup>p</sup> Apart.	77.8 m <sup>2</sup>	30.1 m <sup>2</sup>	28.8 m <sup>2</sup>	6 m <sup>2</sup>	12.9 m <sup>2</sup>

Apartment Y1 (Two)

Quality Housing for Sustainable Communities space provision						
Apartment	Dwelling Type	Gross Floor Area	Aggregate living area	Aggregate bedroom area	Storage	Private Amenity Space
Target	1 Bed 2 <sup>p</sup> Apart.	90 m <sup>2</sup>	34 m <sup>2</sup>	31.5 m <sup>2</sup>	9 m <sup>2</sup>	9 m <sup>2</sup>
Proposed Y1	3 Bed 5 <sup>p</sup> Apart.	115.7 m <sup>2</sup>	36.8 m <sup>2</sup>	48.8 m <sup>2</sup>	10.8 m <sup>2</sup>	25 m <sup>2</sup>

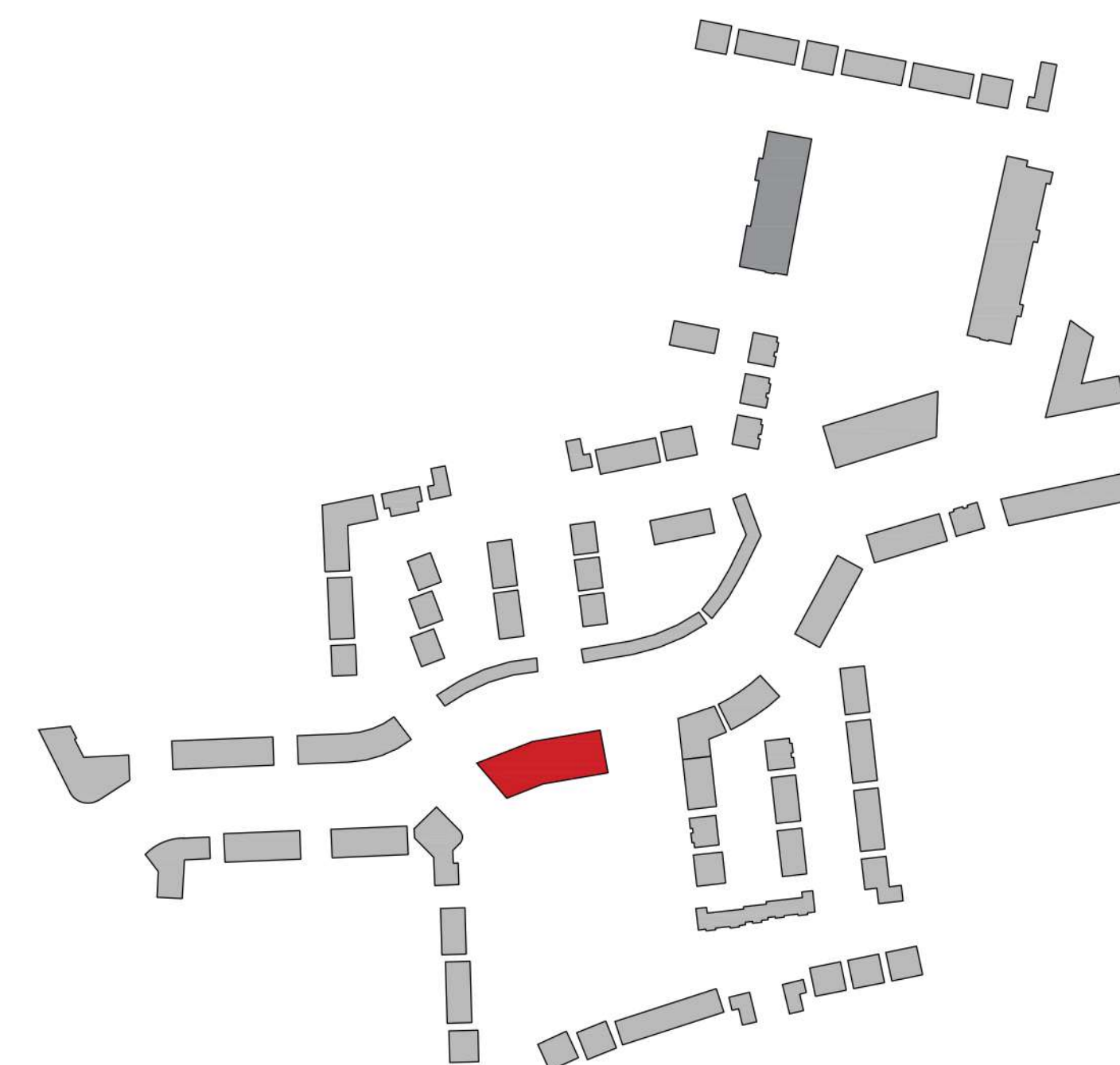

**CPR Note:**  
All works to be carried out using proper materials which are fit for the use they are intended and for the condition in which they are to be used.  
All materials used in connection with the works to comply with the Construction Products Regulation (EU) No. 305/2011 and the harmonised technical specifications/standards that fall within the remit of the CPR No. 305/2011

**van Dijk Architects**  
MILL HOUSE, MILL STREET, DUNDALK, CO. LOUTH  
PH. 042-9354466 FAX. 042-9354466  
INFO@VANDIJKARCHITECTS.COM

---

DRAWING TITLE  
**Part V-Block B-2 Units-First Floor**

---

SCALE: AS INDICATED	DRAWING NUMBER: 1757-PA-071	JOB: CLONMINTH TULLAMORE
DESIGNED BY: AI	CHECKED BY: 1757-PA-BLB	CLIENT: STEINFORT INVESTMENT
DRAWN BY: -	ISSUED BY: AC	DATE: July 2021

---

NOTE:  
FIGURED DIMENSIONS MUST BE USED IN PREFERENCE TO SCALED DIMENSIONS. ANY DIMENSIONAL DISCREPANCIES MUST BE REPORTED TO THE ARCHITECT IMMEDIATELY. THIS DRAWING REMAINS THE COPYRIGHT OF VAN DIJK ARCHITECTS. IT MUST NOT BE USED FOR ANY PURPOSE BUILDING OR OTHERWISE WITHOUT THE EXPRESS PERMISSION OF THIS PRACTICE. DO NOT COPY OR REPRODUCE THESE DRAWINGS OR ANY ADDITIONAL INFORMATION WITHOUT THE EXPRESSED APPROVAL OF VAN DIJK ARCHITECTS